



6314 N Deep groove ball bearings

- SKF Explorer

Deep groove ball bearings

Bearing data

[Tolerances](#),

Normal (metric), P6, P5, Normal (inch),

[Radial internal clearance](#),

Matched bearing pairs, Stainless steel
d < 10 mm, Other bearings

Bearing interfaces

[Seat tolerances for standard conditions](#),

[Tolerances and resultant fits](#)

Technical specification

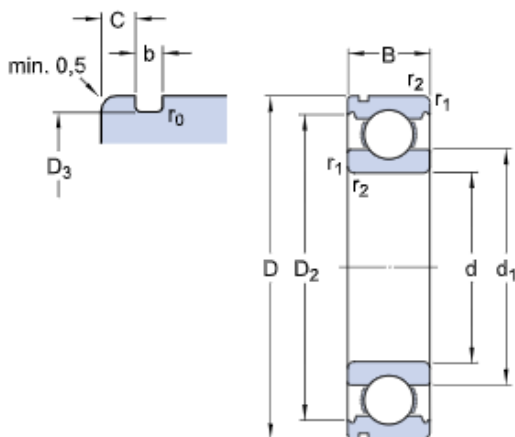

DIMENSIONS

d	70 mm	Bore diameter
D	150 mm	Outside diameter
B	35 mm	Width
d ₁	≈ 94.95 mm	Shoulder diameter
D ₂	≈ 129.9 mm	Recess diameter
D ₃	145.25 mm	Diameter of snap ring groove
b	3.1 mm	Width of snap ring groove
C	4.9 mm	Distance outer ring from side face to snap ring groove
r ₀	max. 0.6 mm	Bottom radius of snap ring groove
r _{1,2}	min. 2.1 mm	Chamfer dimension

ABUTMENT DIMENSIONS

d _a	min. 82 mm	Diameter of shaft abutment
D _a	max. 138 mm	Diameter of housing abutment
D _b	min. 162 mm	Diameter of snap ring recess in the housing
b _a	min. 3.5 mm	Width of snap ring recess in the housing

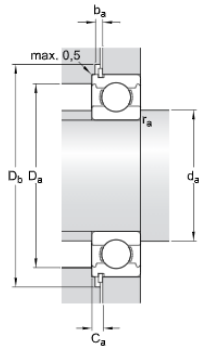

C_a	max. 7.72 mm	Distance from outer ring side face to snap ring back face
r_a	max. 2 mm	Radius of shaft or housing fillet

CALCULATION DATA

C	111 kN	Basic dynamic load rating
C_0	68 kN	Basic static load rating
P_u	2.75 kN	Fatigue load limit
	9 500 r/min	Reference speed
	6 300 r/min	Limiting speed
k_r	0.03	Minimum load factor
f_0	13.2	Calculation factor

MASS

	2.53 kg	Mass bearing
--	---------	--------------

TOLERANCE CLASS

P6	Dimensional tolerances
Normal	Radial run-out